



This plan is for illustration purposes only and is subject to change, error and/or omissions. Landscaping elements and street furniture are approximate only and may change without notice. This plan should not be used for design or construction purposes. Please refer to registered subdivision plan for lot information.

livecopperwood.ca



LOT INFORMATION PLAN

PHASE 32

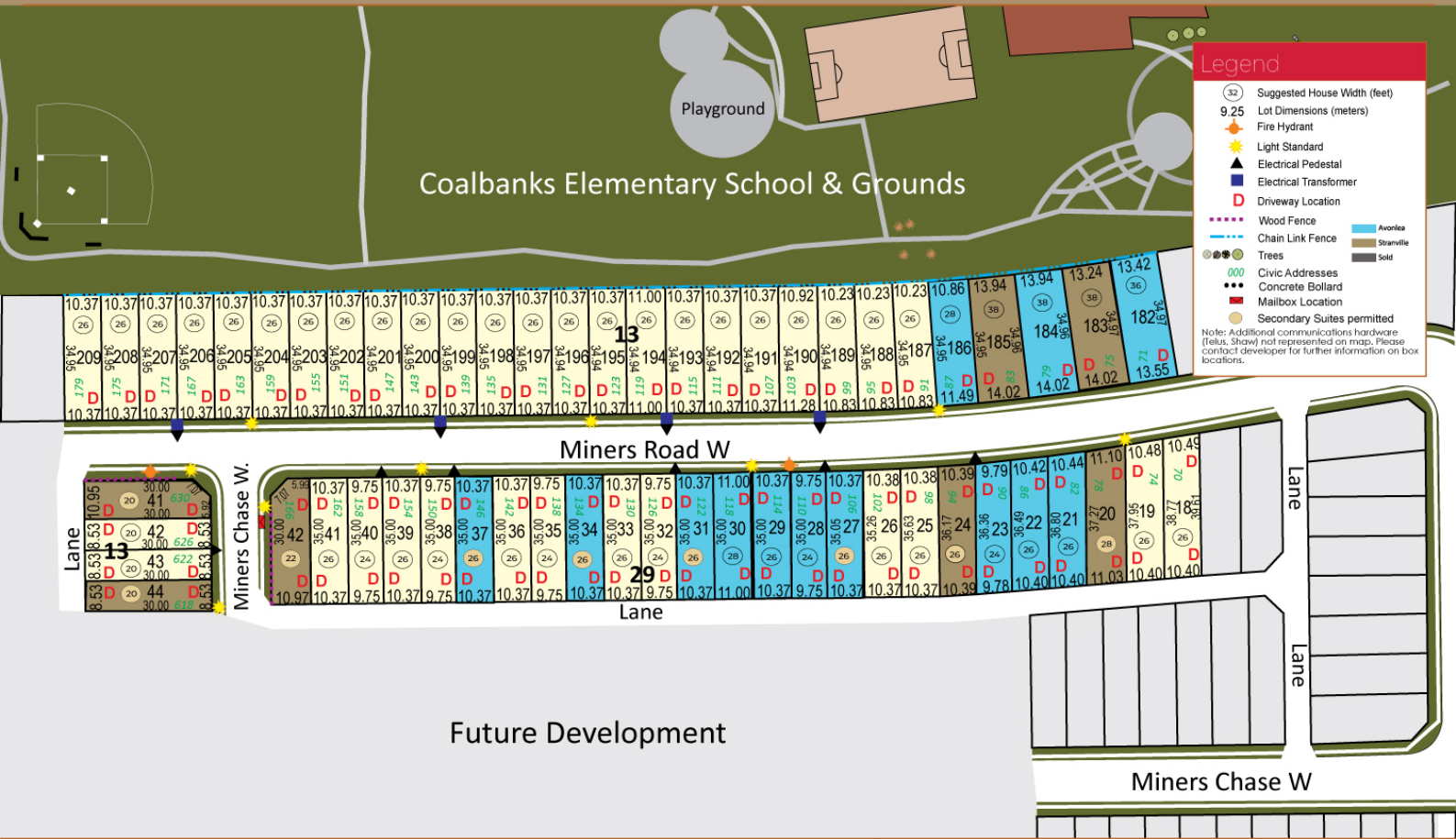

This plan is for illustration purposes only and is subject to change, error and/or omissions. Landscaping elements and street furniture are approximate only and may change without notice. This plan should not be used for design or construction purposes. Please refer to registered subdivision plan for lot information. PLAN # 241607

livecopperwood.ca



This plan is for illustration purposes only and is subject to change, error and/or omissions. Landscaping elements and street furniture are approximate only and may change without notice. This plan should not be used for design or construction purposes. Please refer to registered subdivision plan for lot information.

livecopperwood.ca

PHASE 30/31



- 32 Suggested House Width (feet)
 - 9.25 Lot Dimensions (meters)
 - Fire Hydrant
 - ★ Light Standard
 - ▲ Electrical Pedestal
 - Electrical Transformer
 - D Driveway Location
 - Wood Fence
 - Chain Link Fence
 - Trees
 - 000 Civic Addresses
 - Concrete Bollard
 - Mailbox Location
 - Secondary Suites permitted
 - Future Showhomes (2022/23)
 - Live/Work Townhomes
- Note: Additional communications hardware (Tels. Shaw) not represented on map. Please contact developer for further information on box locations.

