



# Universal Boiler Stand

For  **Triangle  
Tube**

**Boilers & Cascade Systems**

## *Key Features:*

- Fits all Prestige boiler models
- Rugged 12 gauge steel tubing
- No assembly required
- Black powder coat finish
- Adjustable levelling legs
- 1 ½" Square tubing
- Fits Challenger CC 125H & CC 150S models
- Stackable for multiple boiler installations



**Model UBS – 400**



# Universal Boiler Stand

## Dimensions

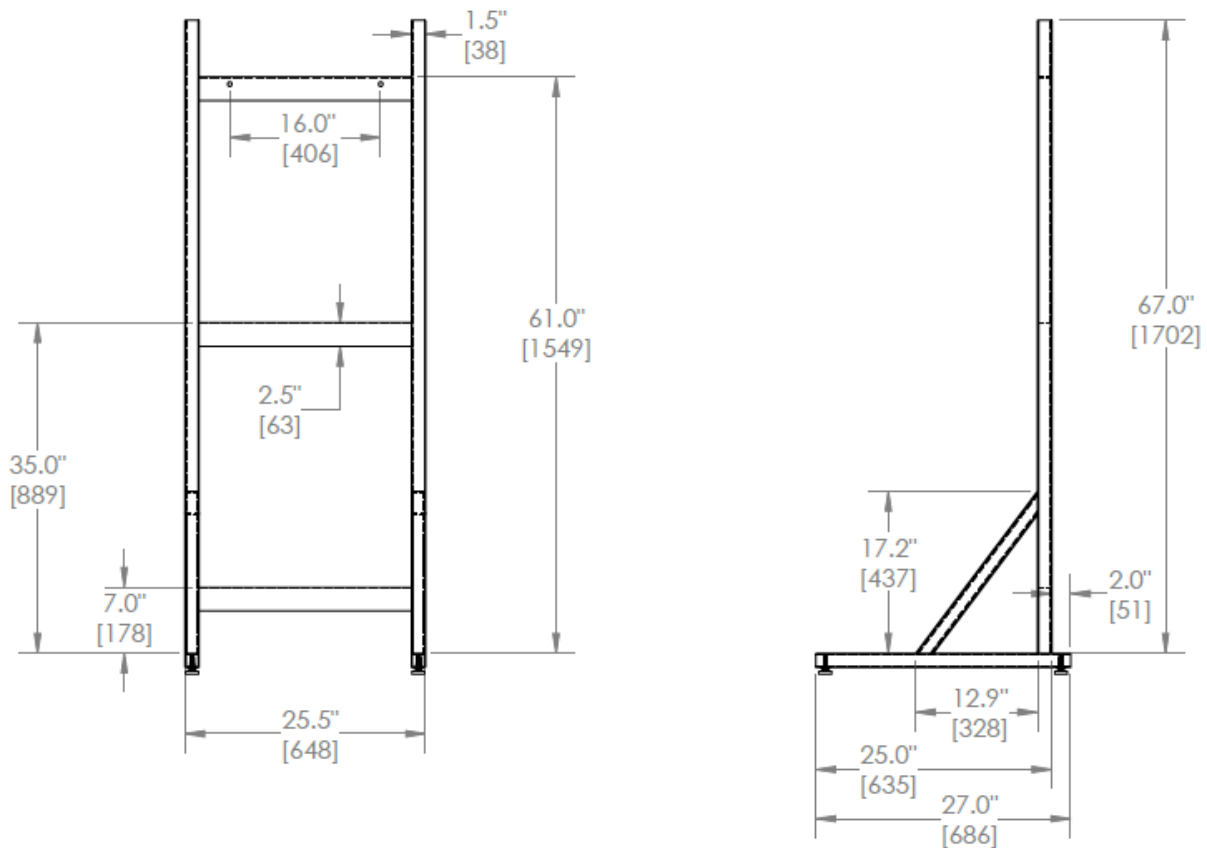

All Dimensions in inches (mm)

Weight: 50 LBS (23Kg)

Product specifications are subject to change without notice