

FENIX™

FENIX™

Fenix™ HP15

The Fenix HP15 Headlamp pushes past current performance boundaries with 500-lumen max output and 172-meter throw. Wear options expand as an exclusive cable extension moves the compact battery box from head to pack as desired. Four AA batteries and five brightness levels deliver capable runtimes. A 125-lumen SOS mode, removable diffuser and 60 degree tilt complete the HP15's total lighting package.

- Utilizes Cree XM-L2 LED with a lifespan of 50,000 hours
- Uses four AA batteries, either Ni-MH or Alkaline
- Light size: 67.4mm (Length) × 55.9mm (Width) × 43.8mm (Height)
- Battery case size : 88.8mm (Length) × 73.7mm (Width) × 26.2mm (Height)
- 162.5-gram weight (excluding batteries and headlamp straps)
- Digitally regulated output maintains constant brightness
- Lockout function – prevents the light from accidental activation
- Detachable diffuser lens
- Remote battery case - reduce the weight worn on the head and optimize battery life in cold conditions.
- 60-degree tilt mechanism
- Reverse polarity protection guards against improper battery installation
- Made from durable aluminum alloy and performance plastic
- Toughened ultra-clear glass lens with anti-reflective coating

HP15

Max 500 Lumens

User Manual

Illuminate Your Adventure

Technical Parameters

ANSI/NEMA FL1	General Mode					SOS	
	Turbo	High	Mid	Low	Eco		
OUTPUT	500 Lumens	275 Lumens	125 Lumens	45 Lumens	4 Lumens	125 Lumens	
RUNTIME	Ni-MH battery	2h*	4h20min	10h	25h20min	206h	
	Alkaline battery	1h30min*	3h00min	14h	30h	220h	
DISTANCE	172m(Max)						
INTENSITY	7420cd(Max)						
IMPACT RESISTANT	1m						
WATER RESISTANT	IPX-6						
ACCESSORIES	Top headband mount, extension cable, cable clip, detachable diffuser lens and AA batteries						

Note: The above-mentioned parameters (lab tested by Fenix using four 2500mAh Ni-MH batteries and the included alkaline batteries) are approximate and may vary between lights, batteries and environments.

*The headlamp will drop down into the High output after working about 3 minutes in the Turbo output. Therefore, the runtime of Turbo output is an accumulated time.

Assemble the Headlamp

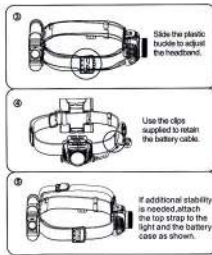
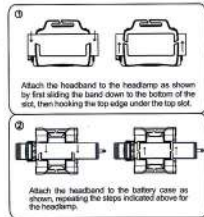

Remote battery case option

If less headband weight is desired or cold weather is compromising battery longevity, attach the extension cable securely on both ends to allow battery box placement in pack or pocket. Route the cable with the top headband mount (included) to avoid tangling or restricted movement.

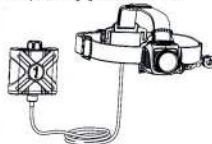

Operation Instruction

ON/OFF

Press the power button once to turn the light on. Press and hold the power button for 0.5 seconds to turn the light off.

Change brightness level

When the light is on, press the power button to cycle through five different brightness levels in the order of Turbo > Eco > Low > Mid > High.

SOS mode

Press and hold the power button for 3 seconds to activate the SOS mode. Press it again to turn the SOS mode off.

Intelligent Memory Circuit

HP15 memorizes the last brightness level used when turned off and back on, but it will not remember the SOS mode.

Over-heat Protection:

The Fenix HP15 Headlamp will accumulate a lot of heat when operating in Turbo output. To avoid overheating, the light will automatically drop down into the high brightness level after working in Turbo output for 3 minutes. If continuous Turbo output is needed, simply reset it.

Battery Specifications

Type	Dimensions	Nominal Voltage	Usability	
Ni-MH Battery	AA	1.2V	Recommended	✓
Alkaline Battery	AA	1.5V	Usable	✓
Non-rechargeable Battery (1.5V)	AA	1.5V	Usable	✓
Rechargeable Battery (3.7V)	14500	3.7V	Banned	✗

Warning: Do not mix batteries of different brands, size, capacity or type. Doing so may cause damage to the flashlight or the batteries being used.

Remove batteries for long-term storage to avoid electrolyte leakage.

Battery Replacement

Unscrew the nut and take out the battery holder to insert the batteries. Replace the holder and securely fasten the nut.

Usage and Maintenance

○ Please don't disassemble the sealed head, as doing so can cause damage to the light and will void the warranty.

○ Use only recommended high performance batteries with this high discharge light. A Ni-MH rechargeable cell is recommended as alkaline batteries will reduce the light's runtime.

○ Please clean the contacts of your light from time to time, especially if the light flickers or doesn't light up. There may be several reasons for a flickering or inoperative light: Reason A: The battery needs replacing.

Solution: Replace the battery with positive (+) and negative (-) terminals properly aligned.

Reason B: The threads, PCB board contact or other contacts are dirty.

Solution: Clean the contact points with an alcohol soaked cotton swab.

If the above methods don't work, please contact the distributor and refer to the warranty policy.

Product Warranty

We will replace products with manufacturing defects within 15 days of purchase and repair a light free of charge within 24 months of purchase if problems develop with normal use; if repair is required after 24 months from the date of purchase, we will charge for parts. The total repair fee is dictated by the cost of the replaced materials.

Product Registration

We kindly suggest that you register your product on the official website of Fenixlight Limited (www.fenixlight.com). You can get an extra six-month warranty period once you have successfully registered. By participating in an optional customer survey, you are entered in a drawing for free Fenix products.

Warning

The Fenix HP15 Headlamp is a high-intensity lighting device capable of causing eye damage. Avoid shining the light directly into the eyes.

The light will accumulate heat after working in the turbo mode for an extended period of time. In order to avoid injury, do not touch the metal part of the light head.

FENIXLIGHT LIMITED

Tel: +86-755-29631932/2929 Fax: +86-755-29631181

www.fenixlight.com

E-mail: info@fenixlight.com

Address: 807, 2nd Building, Dongfang Lighting Industrial Center, 39th District, Bao'an, Shenzhen 518103, China

