



# HL32R-T

## HIGH-PERFORMANCE TRAIL RUNNING HEADLAMP



800 LUMENS  
MAXIMUM OUTPUT



132 METERS MAX  
BEAM DISTANCE

### WARNING

- Do place this headlamp out of the reach of children!
- Do NOT shine the headlamp directly into the eyes of anyone!
- Do NOT shine flammable objects at close range, to avoid burning objects or causing danger due to high temperature!
- Do NOT use the headlamp in inappropriate ways such as biting in the mouth, to avoid personal injury or life threats when the headlamp or internal battery fails!
- This headlamp will accumulate a lot of heat while working, resulting in a high temperature of the headlamp shell. Pay attention to safe use to avoid scalding.
- Turn off and lock the headlamp or remove the battery from the headlamp to prevent accidental activation when the headlamp is placed in a closed and flammable environment such as pockets and backpacks!
- The LED of this headlamp is not replaceable; so the whole headlamp should be replaced when the LED reaches the end of its life.

### (ENGLISH) FENIX HL32R-T HEADLAMP

- Luminus SST20 cold white light, Redshift neutral white light LED; with a lifespan of 50,000 hours.
- Two light sources controlled by two independent switches.
- Powered by one rechargeable ARB-LP1900 Li-ion battery and compatible with 3 x AAA batteries.
- Quality magnesium material, lightweight and durable.
- USB Type-C fast charging interface.
- Frequency sensing: the brightness changes along with the speed.
- Single-handed operation with the new SPORT Headband Fit System.
- Digitally regulated output - maintains constant brightness.
- Reverse polarity protection guards against improper battery installation.
- Size: 2.68" x 1.77" x 1.18" / 68 x 45 x 30 mm.
- Weight: 3.77 oz / 107 grams (including battery).

### OPERATING INSTRUCTION

#### Switches

- Spotlight switch:** for on/off, mode switching, lockout function and output selection on spotlight mode.
- Floodlight switch:** for on/off, mode switching, lockout function and output selection on floodlight mode.

#### On/off

- On: with the lamp switched off, press and hold the right switch for 0.5 seconds to enter the spotlight mode;
- with the lamp switched off, press and hold the left switch for 0.5 seconds to enter the floodlight mode;
- Off: with the lamp switched on, press and hold either of the switches for 0.5 seconds to turn off the lamp.

#### Mode Switching

- In spotlight mode, single click the floodlight switch to activate Low output of floodlight mode.

- In floodlight mode, single click the spotlight switch to activate the last used output of spotlight mode.

#### Output Selection

- In spotlight mode, with the lamp switched on, single click the spotlight switch to cycle through Low→Med→High.

### ①Operating Instruction

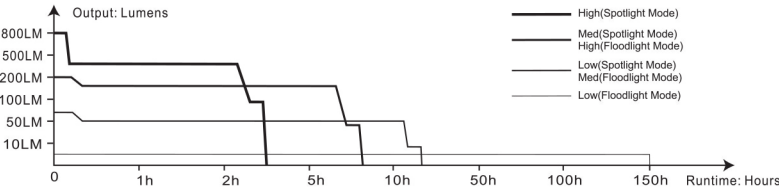
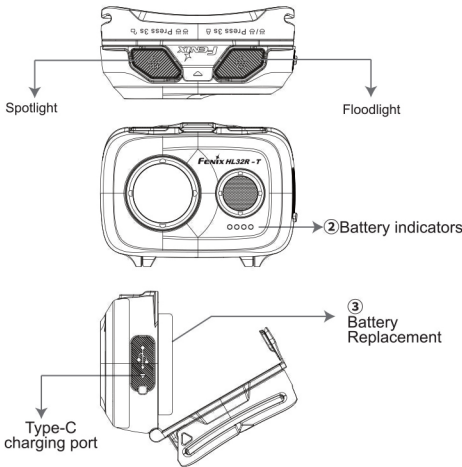

### ④Headband Assembly

#### Shorten the headband

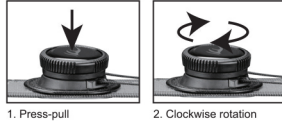

#### Loosen the headband

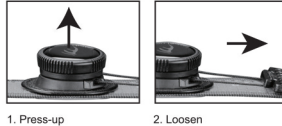

#### Detachable headband



### TECHNICAL PARAMETERS

ANSI/PLATO FL1	SPOTLIGHT MODE			FLOODLIGHT MODE			
	HIGH	MED	LOW	HIGH	MED	LOW	SOS
OUTPUT	800 lumens	200 lumens	70 lumens	200 lumens	70 lumens	5 lumens	5 lumens
RUNTIME	3 hours*	8 hours	20 hours	8 hours	20 hours	150 hours	300 hours
DISTANCE	132 meters	66 meters	38 meters	30 meters	17 meters	5 meters	5 meters
INTENSITY	4333 candela	1090 candela	365 candela	221 candela	75 candela	7 candela	7 candela
IMPACT RESISTANCE	2 meters						
WATERPROOF	IP66						

Note: According to the ANSI/PLATO FL1 standard, the above specifications are from the results produced by Fenix through its laboratory testing using the Fenix ARB-LP1900 battery under the temperature of 21±3°C and humidity of 50% - 80%. The true performance of this product may vary according to different working environments and the actual battery used.

\*The High output is measured in a total of runtime including output at reduced levels due to temperature or protection mechanism in the design.

In floodlight mode, with the lamp switched on, single click the floodlight switch to cycle through Low→Med→High→SOS.

#### Lock/Unlock

**Lock:** when the lamp is switched off, press and hold either of the switches, or simultaneously press the two switches for 3 seconds, the lamp will blink four times on Low of floodlight mode to indicate locked status.

**Unlock:** when the lamp is locked, simultaneously press the two switches for 3 seconds, the lamp will be activated with 4 one-second blinks and activated on Low of floodlight mode.

In locked status, clicking or pressing the switches will activate 4 one-second blinks on Low of floodlight mode to indicate locked status.

#### Intelligent Memory Circuit

With the lamp switched off, turn on the lamp to enter the spotlight mode; the headlamp memorizes the last selected output on spotlight mode; floodlight mode cannot memorize the last selected output. Each time the floodlight mode is entered with Low output of floodlight mode.

With the lamp switched on, while switching between the two modes, the headlamp memorizes the output of either of the modes.

### BATTERY SPECIFICATIONS

TYPE	DIMENSIONS	NOMINAL VOLTAGE	USABILITY
Fenix ARB-LP1900	Special battery	3.8V	Recommended ✓✓
Alkaline Battery	AAA	1.5V	Usable ✓
Ni-MH Battery	AAA	1.2V	Usable ✓
Rechargeable Battery (Li-ion)	10440	3.7V	Banned ✗

Warning: Do not mix batteries of different brands, sizes, capacities or types. Doing so may cause damage to the headlamp or the batteries being used.  
\*Only use recommended or usable batteries. Only use quality batteries with circuit protection will reduce the potential for combustion or explosion; but cell damage or short circuiting are potential risks the user assumes.

### BATTERY REPLACEMENT

1. Pull battery cover latch with Fenix logo that is located between the switches to open the tail cap.
2. Insert the battery/batteries in accordance with the polarity marks.
3. Replace the tail cap.

### FREQUENCY SENSING

As the user's step frequency increases or decreases, the brightness will gradually increase or decrease accordingly.

### CHARGING

1. Uncover the left anti-dust cap and plug the USB Type-C side of the charging cable into the charging port of the lamp; when charging is complete, replace the anti-dust cap to ensure waterproof and dustproof ability.
2. In charging process, four indicators flash: below 20%, one constant-on and three flash; 20% - 50%, two constant-on and two flash; 50% - 80%, three constant-on and one flash; 80% - 95%, four constant-on; charging complete.
3. When charging, the Low of either of the modes can be used.
4. The normal charging time is 3 hours from depletion to full charging.

#### Note:

1. The headlamp has a charging protection function. It will automatically end charging and indicating when the detected temperature is higher than 65°C.
2. Recharge a stored headlamp every four months to maintain optimal battery performance.

## LIGHTING FOR EXTREMES



FACEBOOK



WECHAT

"Follow" us for more information about Fenix.

### FENIXLIGHT LIMITED

Tel: +86-755-29631163/83/93 Fax: +86-755-29631181

E-mail: info@fenixlight.com Web: www.fenixlight.com

Address: 2F/3F, West of Building A, Xinghong Technology Park, 111 Shuike Road, Fenghuanggang Community, Xixiang Street, Bao'an District, Shenzhen City, Guangdong Province, China



61.149.221.070-A2-20230418

### BATTERY LEVEL INDICATION

With the light switched off, single click either of the switches to check the battery level and indicator(s) will last for 3 s.  
Four blue lights on: 100% - 80%  
Three blue lights on: 80% - 60%  
Two blue lights on: 60% - 40%  
One blue light on: 40% - 20%  
One blue light flashes: 20% - 1%

Note: This only works with Fenix ARB-LP1900 battery.

### LOW-VOLTAGE WARNING

When the voltage level drops below the preset level, the headlamp is programmed to downshift to a lower brightness level until Low output is reached. When this happens in Low output, the battery level indicator blinks to remind you to timely recharge or replace the battery.

Note: This only works with Fenix ARB-LP1900 battery.

### INTELLIGENT OVERHEAT PROTECTION

The lamp will accumulate a lot of heat when used at relatively high output levels for extended periods. When the lamp reaches a temperature of 65°C or above, the lamp will automatically step down a few lumens to reduce the temperature. When the temperature drops below 65°C, it will then allow the user to reselection the modes.

### HEADBAND ASSEMBLY

1. The headband is factory assembled by default.
2. Adjust the headband by sliding the buckle to the required length.

### USAGE AND MAINTENANCE

Disassembling the sealed head can cause damage to the lamp and void the warranty.

Fenix recommends using an excellent quality Fenix battery.  
If the lamp will not be used for an extended period, remove the battery, or the lamp could be damaged by electrolyte leakage.

Lock the lamp or take out the battery to prevent accidental activation during storage or transportation.

Long-term use can result in O-ring wear. To maintain a proper water seal, replace the ring with an approved spare.

Periodic cleaning of the battery contacts improves the lamp's performance as dirty contacts may cause the lamp to flicker, shine intermittently or even fail to illuminate for the following reasons:

**A:** The battery needs replacing.

**Solution:** Replace the battery (Ensure the battery is inserted according to the manufacturer's specifications).

**B:** The contact points in contact of the battery or headlamp is dirty.

**Solution:** Clean the contact points with a cotton swab soaked in rubbing alcohol.

If the above methods don't work, please contact the distributor.

### INCLUDED

Fenix HL32R-T headlamp, Fenix ARB-LP1900 battery, USB Type-C charging cable, User manual, Warranty card