



CL30R

Max 650 Lumens

User manual

Illuminate Your Adventure

Fenix CL30R Camping Lantern

The Fenix CL30R rechargeable camping lantern offers flexibility in power, charging and brightness levels. This versatile lantern not only features a Micro USB port to recharging, but it is the first Fenix lantern that serves as an independent charging station for other devices. The powerful CL30R delivers a maximum output of 650 lumens, which illuminates an area 35 meters in diameter. Powered by one, two or three 18650 rechargeable batteries, this lantern offers five brightness levels, Turbo and Flash. The CL30R features a cold-resistant battery compartment for all-season use, charging and battery-level indicators for accurate operation, and a hanging lanyard and tripod socket for flexible lighting options.

- ✗ Max 650 lumens, wide-range and high-intensity luminance
- ✗ Powered by one, two or three 18650 rechargeable Li-ion batteries
- ✗ Serves as a portable power bank
- ✗ Excellent cold-resistant design
- ✗ Integrated Micro-USB charging with battery level indicator and low-voltage warning function
- ✗ 35-meter diameter wide-range beam
- ✗ Waterproof to IPX-7 standard
- ✗ Reverse polarity protection, to protect from improper battery installation
- ✗ Tripod socket for easy attachment
- ✗ Single button switch for easy and fast operation

Parts Included

- | | |
|--|------|
| 1. CL30R camping lantern | 1PCS |
| 2. Spare O-ring for water seal | 1PCS |
| 3. User Manual | 1PCS |
| 4. Warranty card | 1PCS |
| 5. Micro-USB cable | 1PCS |
| 6. ARB-L18-2600 rechargeable 18650 battery | 3PCS |

Technical Parameters		General Mode					Flash	
		Turbo	High		Mid	Low		Eco
OUTPUT		650 Lumens	350 Lumens	100 Lumens	50 Lumens	10 Lumens	100 Lumens	
RUNTIME	2600mAh	4h30min	9h		38h	70h	300h	70h
	3500mAh	6h	12h		51h	93h	400h	93h
DISTANCE					35m			
WATER RESISTANCE					IPX-7			
IMPACT RESISTANCE					1m			
WEIGHT		412 g(excluding batteries and other accessories)						
DIMENSION		93 mm (Length) x 93mm (Width) X 136mm (Height)						

Note: The above-mentioned parameters (lab-tested by using three Fenix ARB-L18-3500 and the included Fenix ARB-L18-2600 18650 rechargeable Li-ion batteries) are approximate and may vary between flashlights, batteries and environments.

Operation Instruction

ON/OFF

Press and hold the switch for 0.8 seconds to turn ON/OFF the camp lantern.

Output Selection

When the lantern is on, single-click the switch to cycle through Eco→Low→Mid→High→Turbo.

With the lantern on, double-click the switch to enter into Flash mode and single-click to turn back to previous state.

The camp lantern only lights up at Mid output when being charged.

Battery Level Indicator

With the light off, single-click the side switch to enter power display. The number of the constant-on light shows the battery power.

One shows the battery power is less than 35%, two constant-on show the range 36%-60%, three constant-on show the range 61%-85%, four constant-on show the battery power is over 85%. The indicator light will go out after 8 seconds.

Intelligent Memory Circuit

The lantern memorizes the last-used brightness level in General Mode. Next time you turn it on, it will recall the previously used brightness level in General Mode.

Low-voltage Warning Function

When the voltage level drops below the preset level, the indicator light on the switch blinks to remind you to recharge the camp lantern or replace the battery. To ensure normal use, the camp lantern will not turn off automatically until the battery runs out.

Note: This only works on 18650 Li-ion batteries with button top.

Charging

To Charge the CL30R

When charging, connect the USB cable to a USB power adaptor (sold separately), and remove the anti-dust plug of the camp lantern to reveal the charging port and plug the Micro-USB end of the USB cable into the lantern's charging port. Then the indicator light on the top flash in turns to indicate the charging process has begun. The indicator turns solid green when the battery is fully charged. Fenix recommends using a power adaptor with output 5V, 1.5A. It takes about 8.5 hours to fully charge three 2600mAh Fenix ARB-L18-2600mAh 18650 Li-ion batteries as originally included with the camping lantern.

To Charge other Devices

The camp lantern can be connected to USB cables for digital products such as mobile phones with standard Micro-USB charging port.

Note: 1. Once charging is completed, disconnect the USB cable from the lantern and be sure to secure the anti-dust plug covered.

2. Please do not charge the camping lantern when the light is turned on, doing so will extend the charging time or the battery can not be fully charged. If emergency lighting needed, the camp lantern only lights up at Mid output when being charged.

Battery Specifications

Type	Dimensions	Nominal Voltage	Usability	
Fenix ARB-L18 Series	18650	3.6V/3.7V	Recommended	✓✓
Non-rechargeable Battery (Lithium)	CR123A	3V	Cautious*	!
Rechargeable Battery (Li-ion)	16340	3.6V/3.7V	Banned	✗
Rechargeable Battery (Li-ion)	18650	3.6V/3.7V	Cautious**	!
Rechargeable Battery (LiFePO4)	18650	3.2V	Banned	✗

Warning: 1. Please do not mix batteries of different brands, size, capacity or type. Doing so may cause damage to the camping lantern or the batteries being used.
2. Do not use the camping lantern to charge the banned batteries, or it may cause explosion.
3. The lantern only compatible with the 18650 battery with button top.

*If not necessary, please do not use CR123A batteries, let alone charge the lantern or discharge the lantern for charging other devices.

**18650 Li-ion batteries are power cells designed for commercial applications and must be treated with caution and handled with care. Quality batteries with circuit protection will reduce the potential risk for combustion or explosion but cell damage or short circuiting are potential risks the user assumes.

Battery Replacement

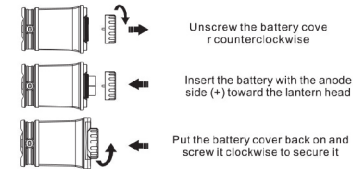

Note: The camping lantern is shipped with Fenix 2600 mAh ARB-L18-2600 18650 rechargeable Li-ion battery. Please remove the battery insulation tab before first use.

Usage and Maintenance

- ✗ Disassembling the sealed head can cause damage to the light and will void the warranty.
- ✗ Fenix recommends using excellent quality battery. If the flashlight will not be used for an extended period, remove the battery, or the flashlight could be damaged by electrolyte leakage or battery explosion.

- ✗ Long-term use can result in O-ring wear. To maintain a proper water seal, replace the ring with an approved spare.
- ✗ Periodic cleaning of the battery contacts improves the flashlight's performance as dirty contacts may cause the flashlight to flicker, shine intermittently or even fail to illuminate for the following reasons:
Reason A: The batteries need replacing.
Solution: Replace batteries (Please confirm the correct installation of anode and cathode).
Reason B: The threads, PCB board contact or other contacts are dirty.
Solution: Clean the contact points with a cotton swab soaked in rubbing alcohol.
If the above methods don't work, please refer to the warranty policy before contacting your authorized distributor.

Product Warranty

Fenix will replace products with documented manufacturing defects within 15 days of purchase and repair a light free of charge within 5 years (Rechargeable battery: 1 year) of purchase if problems develop with normal use; if repair is required after 5 years from the date of purchase, Fenix will charge for parts. The total repair fee is dictated by the cost of the replaced materials.

Product Registration

Fenix suggests you register your product on the official website for Fenixlight Limited (www.fenixlight.com). You can get an extra six-month warranty period once you have successfully registered. By participating in an optional customer survey, you are entered in a drawing for free Fenix products.

Warning

Fenix suggests you register your product on the official website for Fenixlight Limited (www.fenixlight.com). You can get an extra six-month warranty period once you have successfully registered.