

SITE LAND USE	DWELLING TYPE	UNITS	PARKING REQUIRED	PARKING PROVIDED	VISITOR PARKING RERQUIRED
BLOCK 101	FRONT LOADED TH	8	1.5/UNIT = 12	2/UNIT = 16	0
BLOCK 102	STACKED TH	88	1.5/UNIT = 132	0/UNIT = 0	132
BLOCK 103	FRONT LOADED TH	12	1.5/UNIT = 18	2/UNIT = 24	0
BLOCK 104	FRONT LOADED TH	4	1.5/UNIT = 6	2/UNIT = 8	0
BLOCK 105	STACKED TH	84	1.5/UNIT = 126	2/UNIT = 168	0
BLOCK 106	FRONT LOADED TH	4	1.5/UNIT = 6	2/UNIT = 8	0
BLOCK 107	FRONT LOADED TH	4	1.5/UNIT = 6	2/UNIT = 8	0
BLOCK 108	FRONT LOADED TH	4	1.5/UNIT = 6	2/UNIT = 8	0
BLOCK 109	FRONT LOADED TH	3	1.5/UNIT = 4.5	2/UNIT = 6	0
BLOCK 110	STACKED TH	32	1.5/UNIT = 48	0/UNIT = 0	48
BLOCK 111	FRONT LOADED TH	14	1.5/UNIT = 21	2/UNIT = 28	0
LOT 1	SINGLE DETACHED	1			
SITE TOTAL		258	387	274	180

VISITOR PARKING SPACES	
ON-STREET	PARKING LOT
62	196
SITE TOTAL	258

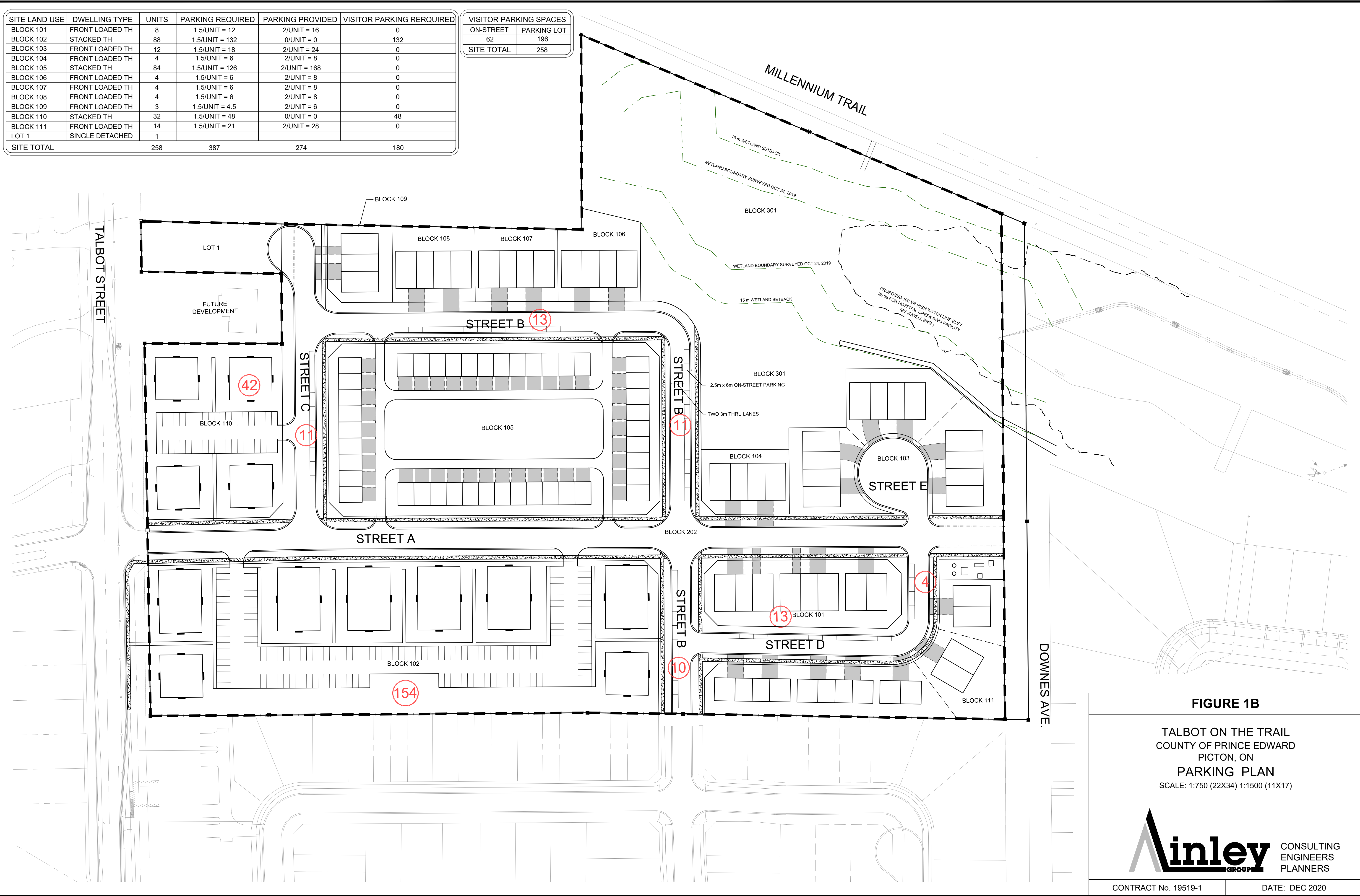

FIGURE 1B

TALBOT ON THE TRAIL
 COUNTY OF PRINCE EDWARD
 PICTON, ON
PARKING PLAN
 SCALE: 1:750 (22X34) 1:1500 (11X17)



K:\Projects\19519 - Talbot on the Trail\19519-1 Project - Talbot on the Trail\Drawings - Exhibits\Report Figures\19519-1 - Parking Plan.dwg, 2020-12-11 2:05 PM